

LEGEND

- LV POLE
- HV POLE
- HV & LV POLE
- △ PROP. POLE MOUNTED TRANSFORMER
- ▲ EXIST. POLE MOUNTED TRANSFORMER
- EXISTING O/H CONDUCTOR
- - - PROPOSED O/H CONDUCTOR
- GROUND STAY
- FLY STAY
- FLY/GROUND STAY

POLE SCHEDULE

POLE NO.	POLE DESCRIPTION WOOD/CONC OR EXIST	POLE LENGTH STRENGTH H m/kN	SPAN m	ANGLE OF DEVIATION IN DEG.	POLE TOP DESCRIPTION OR DRESSINGS	STAYS			REMARKS
						GRND	FLY	FLY +GRND	
A	EXIST.	EXIST.	EXIST.	-	EXIST+14B	EXT			EXIST + UPGRADE EXIST 10 HV TO PROP 30 HV
B	EXIST.	EXIST.	47	45	EXIST+12B	EXT			" " " " " " " " " "
C	EXIST.	EXIST.	40	0	EXIST+11B	EXT			" " " " " " " " " "
D	EXIST.	EXIST.	39	6	EXIST+11B	EXT			" " " " " " " " " "
E	EXIST.	EXIST.	39	3	EXIST+11B	EXT			" " " " " " " " " "
F	EXIST.	EXIST.	56	9	EXIST+11B	EXT			" " " " " " " " " "
G	EXIST.	EXIST.	34	8	EXIST+11B	EXT			" " " " " " " " " "
H	EXIST.	EXIST.	30	13	EXIST+14B	EXT			" " " " " " " " " "
I	EXIST.	EXIST.	30	10	EXIST+11B	EXT			EXIST + PROP 30 HV
1	CONC.	10.2/6	46	3	11B				PROP 30 HV ONLY
2	CONC.	10.2/6	63	2	11B				" " " " " " " " " "
3	CONC.	10.2/6	85	14	11B	1			" " " " " " " " " "
4	CONC.	10.2/6	65	50	14B	1			" " " " " " " " " "
5	CONC.	10.2/6	63	19	11B		1		" " " " " " " " " "
6	CONC.	10.2/6	86	4	11B				" " " " " " " " " "
7	CONC.	10.2/6	106	20	12B		1		" " " " " " " " " "
8	CONC.	10.2/6	85	1	11B				" " " " " " " " " "
9	CONC.	10.2/6	75	56	14B	1			" " " " " " " " " "
10	CONC.	10.2/6	89	77	14B+3A	2			PROP 30 HV + PROP 10 LV
11	CONC.	10.2/6	86	42	12B+2A		1		" " " " " " " " " "
12	CONC.	10.2/6	83	18	11B+1A	1			" " " " " " " " " "
13	CONC.	10.2/6	72	18	11B+1A		1		" " " " " " " " " "
14	CONC.	10.2/6	69	0	11B+1A				" " " " " " " " " "
15	CONC.	10.2/6	94	43	12B+2A				" " " " " " " " " "
16	CONC.	10.2/6	87	80	13B+13B+3A+3A	2			" " " " " " " " " "
17	CONC.	10.2/6	93	16	11B+1A	1			" " " " " " " " " "
18	CONC.	10.2/6	95	45	14B+4A	1			" " " " " " " " " "
19	CONC.	10.2/6	41	3	11B+1A				" " " " " " " " " "
20	CONC.	11/5.5	73	9	11B+1A	1			PROP 30 HV + PROP 10 LV + PROP 5kVA TXFR
21	CONC.	10.2/6	57	85	13B+13B+3A+3A	2			" " " " " " " " " "
22	CONC.	10.2/6	84	78	13B+13B+3A+3A	2			" " " " " " " " " "
23	CONC.	10.2/6	50	26	11B+1A		1		" " " " " " " " " "
24	CONC.	10.2/6	85	7	11B+1A				" " " " " " " " " "
25	CONC.	10.2/6	89	48	14B+4A	1			" " " " " " " " " "
26	CONC.	10.2/6	110	2	11B+1A				" " " " " " " " " "
27	CONC.	10.2/6	91	13	11B+1A	1			" " " " " " " " " "
28	CONC.	10.2/6	100	6	11B+1A				" " " " " " " " " "
29	CONC.	10.2/6	88	72	13B+13B+3A	2			" " " " " " " " " "
30	CONC.	10.2/6	79	4	11B				PROP 30 HV ONLY
31	CONC.	10.2/6	79	36	12B		1		" " " " " " " " " "
32	CONC.	10.2/6	80	45	14B	1			" " " " " " " " " "
33	CONC.	10.2/6	85	26	12B	1			" " " " " " " " " "
34	CONC.	10.2/6	80	85	13B+13B	2			" " " " " " " " " "
35	CONC.	10.2/6	31	20	11B	1			" " " " " " " " " "
36	CONC.	10.2/6	98	2	11B				" " " " " " " " " "
37	CONC.	10.2/6	70	7	13B+13B+3A+3A		1		PROP 30 HV + PROP 10 LV
37/1	WOOD.	10.2/6	77	-	3A	1			PROP 10 LV ONLY
38	CONC.	10.2/6	77	53	14B+4A	1			PROP 30 HV + PROP 10 LV
39	WOOD.	10.2/6	96	65	14B+4A+3A	1			" " " " " " " " " "
39/1	WOOD.	10.2/6	37	-	3A	1			PROP 10 LV ONLY
40	WOOD.	10.2/6	32	9	11B+1A				PROP 30 HV + PROP 10 LV
41	WOOD.	11.0/5.5	90	26	13B+1A+3A	1			PROP 30 HV + PROP 10 LV + PROP 30kVA TXFR
41/1	WOOD.	10.2/6	48	-	3A	1			PROP 10 LV ONLY
42	WOOD.	10.2/6	60	35	2A	1			" " " " " " " " " "
43	WOOD.	10.2/6	57	13	1A				" " " " " " " " " "
44	WOOD.	10.2/6	67	57	4A	1			" " " " " " " " " "
45	WOOD.	10.2/6	88	13	1A	1			" " " " " " " " " "
46	WOOD.	10.2/6	70	7	1A				" " " " " " " " " "
47	WOOD.	15.5	97	33	4A	1			" " " " " " " " " "
47/1	WOOD.	15.5	-	-	-	1			H - POLE STRUCTURE
48	WOOD.	15.5	274	15	4A	1			PROP 10 LV ONLY
48/1	WOOD.	15.5	-	-	-	1			H - POLE STRUCTURE
49	WOOD.	10.2/6	83	-	3A	1			PROP 10 LV ONLY

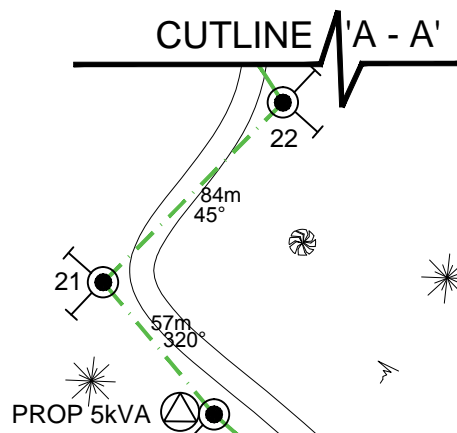

SUBJECT AREA

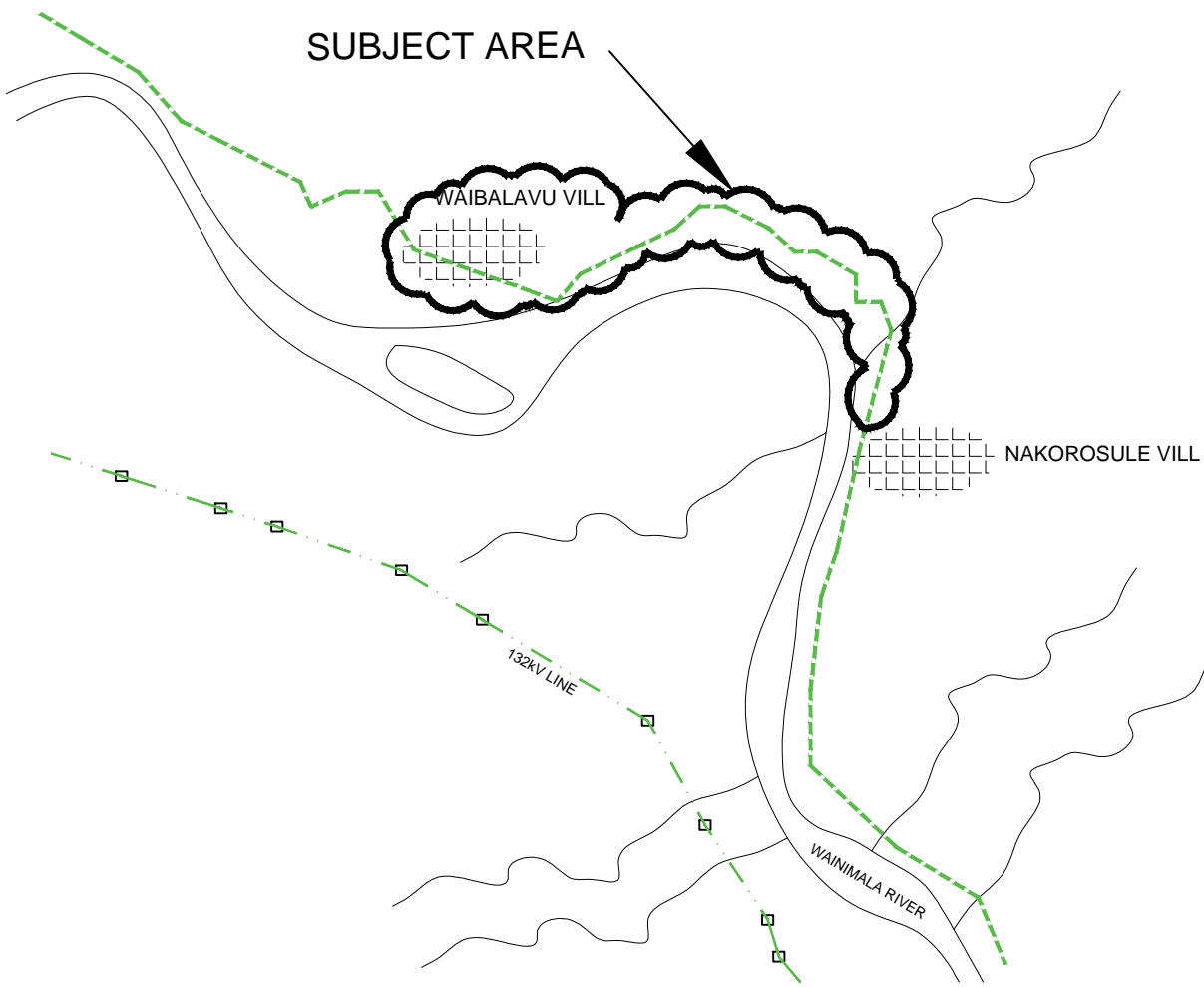

LOCALITY PLAN (NTS)

WAINIMALA RIVER

FINAL SINGLE LINE DIAGRAM  
REF. DRWG 04 N10 020

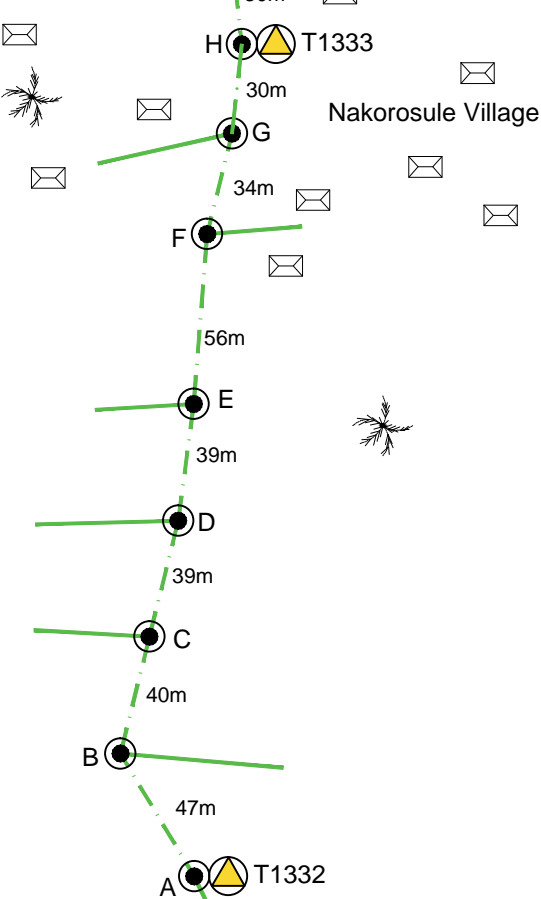
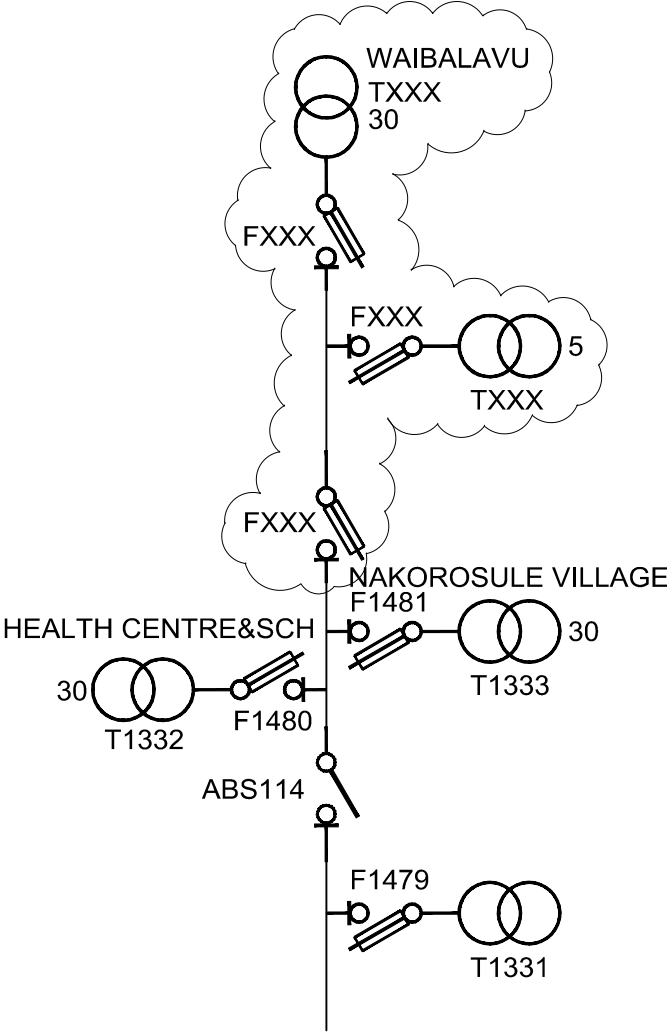

0	ORIGINAL ISSUE FOR SI No. VU01.16	11.04.18	R.R						
No.	REVISION	DATE	BY	CHK	PSD	APP			

REFERENCE

CAD FILENAME	C:\PROJECTS\XXXXXXX.DWG
DRAWING No.	TITLE



DRAWN	RAULUJORO R	11.04.18
CHECKED		8/5/18
CHIEF DRAUGHTSMAN		
TEAM LEADER PLANNING & DESIGN		04.05.18
ENGINEER		
HEAD OF DEPARTMENT	K. Prasad	7/05/18

ENERGY FIJI LIMITED

SUPPLY TO TAITUSI & 49 OTHERS  
NAITASIRI DISTRICT  
WAIBALAVU VILLAGE (VU01.16)

DRAWING NUMBER

A1 04 N79 044

SCALE 1 : 2500