

LEGEND

- LV POLE
- HV POLE
- HV & LV POLE
- ⊙ PROP. POLE MOUNTED TRANSFORMER
- ⊙ EXIST. POLE MOUNTED TRANSFORMER
- EXISTING O/H CONDUCTOR
- - - PROPOSED O/H CONDUCTOR
- GROUND STAY
- FLY STAY
- FLY/GROUND STAY

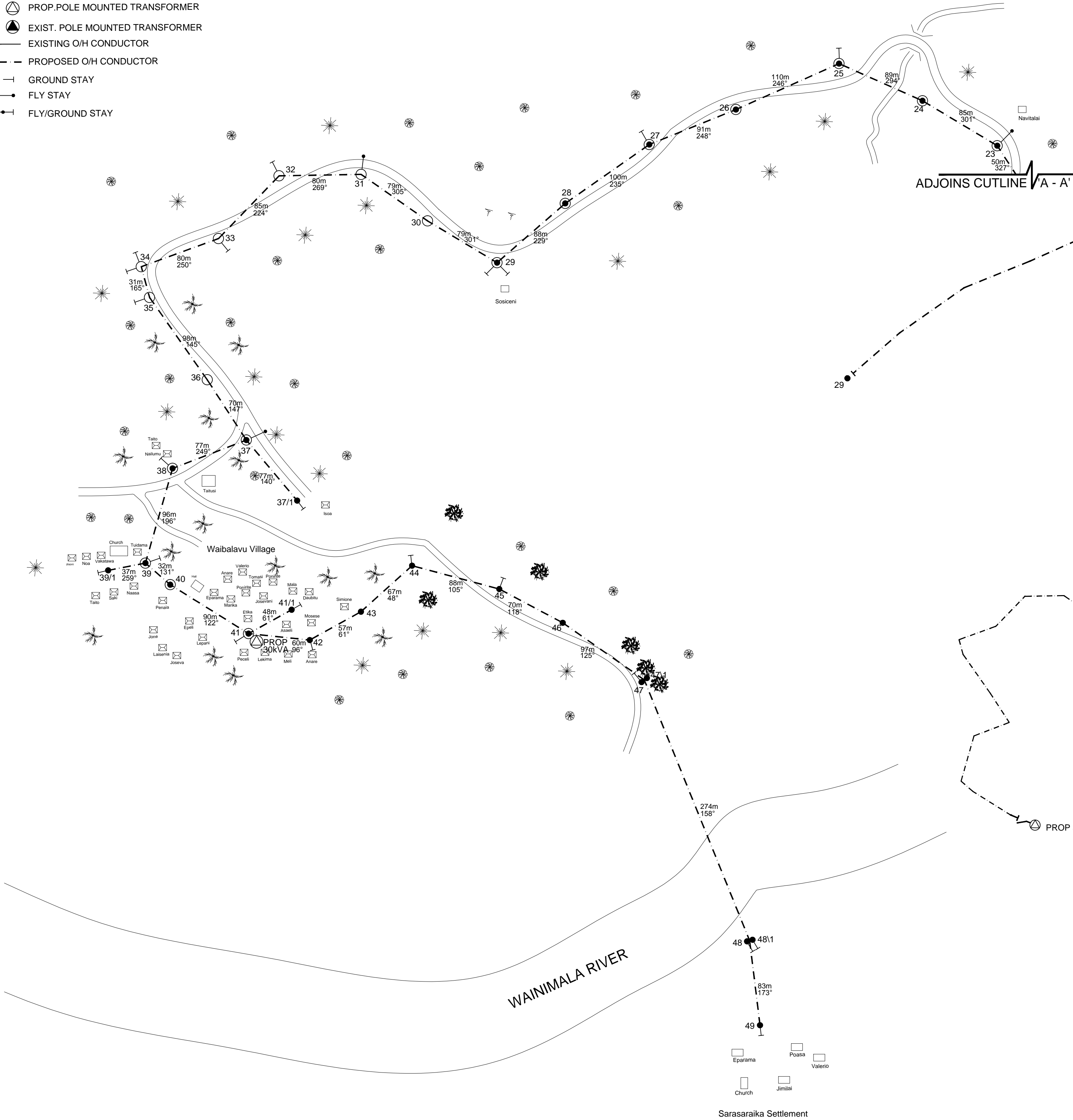

ADJOINS CUTLINE A - A'

LV CIRCUIT

LEGEND - LV CIRCUIT

- ⊙ PROPOSED TRANSFORMERS
- TERMINATION POINT
- ⊙ STRAIN POINT
- ⊙ BRIDGING POINT
- - - STRING 7/3.75AAAC HELIUM CONDUCTOR.
TOTAL ROUTE LENGTH 1Ø LV = 2959m

FINAL HV CIRCUIT

LEGEND - HV CIRCUIT

- DROPOUT FUSE & ABS
- ⊙ EXIST. TRANSFORMERS
- ⊙ PROP. TRANSFORMERS
- EXISTING 3Ø HV CONDUCTOR
- - - STRING 3X 73.75 AAAC HELIUM CONDUCTOR
ROUTE LENGTH = 3426m

No.	REVISION	DATE	BY	CHK	PSD	APP
0	ORIGINAL ISSUE FOR SI No. VU01.16	11.04.18	R.R.			

REFERENCE

CAD FILENAME	C:\PROJECTS\XXXXXXX.DWG
DRAWING No.	TITLE



SHEET 2 OF 2

DRAWN	RAULUOR R	11.04.18
CHECKED		8/5/18
CHIEF DRAUGHTSMAN		
TEAM LEADER PLANNING & DESIGN		04.05.18
ENGINEER		
HEAD OF DEPARTMENT	K. Prasad	7/05/18

ENERGY FIJI LIMITED

SUPPLY TO TAITUSI & 49 OTHERS
NAITASIRI DISTRICT
WAIBALAVU VILLAGE (VU01.16)

DRAWING NUMBER

A1 04 N79 044

SCALE 1 : 2500