

PRODUCT DRAWING

UNRESTRICTED RELEASE

PART CODE	CSA	CONDUCTOR	CU DIE	GENERAL DIMENSIONS				APPROX. MASS (kg)
				A	B	F	J	
EPTECU-40-10.4AF-M12	40	19.064 (1.63) PHC	DCu50 (10.4AF)	75	30	31	25	0.05
EPTECU-70-11.5AF-M12	70	19.083 (2.11) PHC	DCu70 (11.5AF)	95	40	37	31	0.06

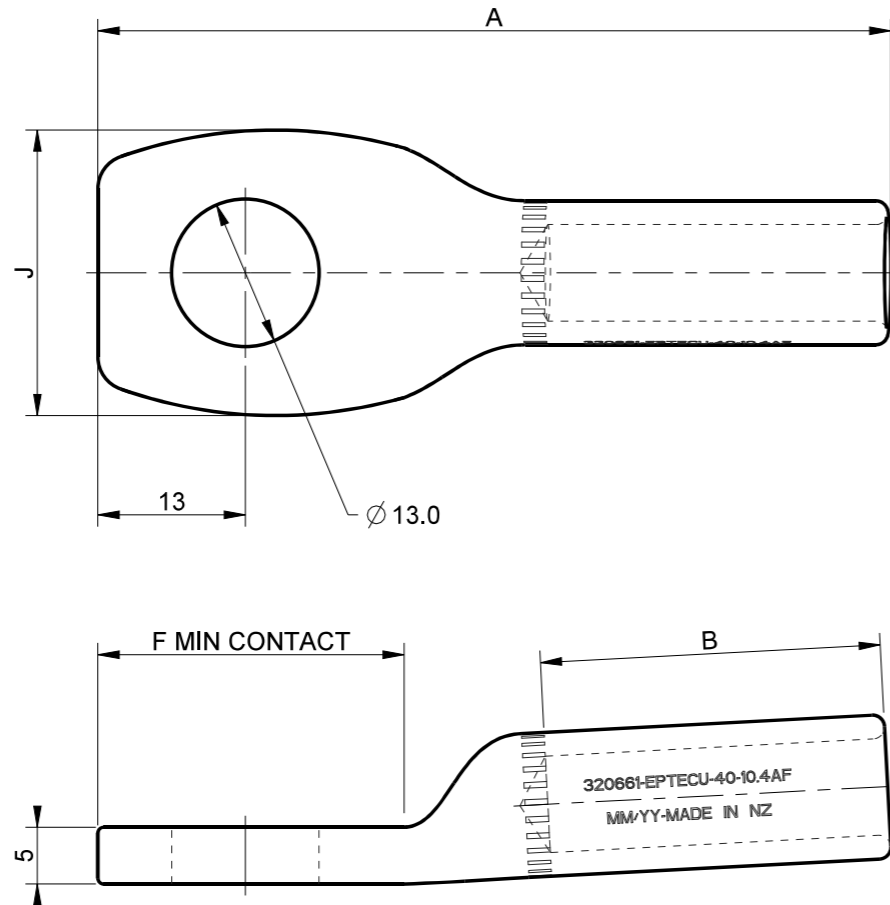

(EXAMPLE SHOWN FOR EPTECU-40-10.4AF)



NOTES

1. MATERIAL: FORGED HIGH CONDUCTIVITY COPPER
2. FINISH: NATURAL
3. COPPER COMPRESSION TERMINALS SHALL CONFORM TO REQUIREMENTS OF IEC 61238. ELECTRICAL RATING: CLASS B
4. FITTING SHALL BE FILLED WITH JOINTING COMPOUND

UNITS MILLIMETERS		ELECTROPAR NEW ZEALAND	
DO NOT SCALE			
THIRD ANGLE PROJECTION 		CONFIDENTIAL THIS DRAWING IS THE EXCLUSIVE PROPERTY OF PREFORMED LINE PRODUCTS COMPANY AND IS TO BE USED ONLY WITH THE PRIOR EXPRESSED PERMISSION OF PLP	
TOLERANCES UNLESS NOTED x ± 1 x.x ± 0.4		PRODUCTION DRAWING TITLE COPPER COMPRESSION TERMINAL EPTECU	
QUALITY PLAN		DRAWN BY SM	PART NUMBER CON-TECU
QTY. 0	LABEL [C]	DATE DRAWN 22.09.16	DRAWING NUMBER 5307
0	[V]	SCALE NTS	SHEET No 4 OF 4
	VISUAL INSPECTION	ORIGIN	REV D