

A

B

C

D

E

F

EPC ITEM NUMBER
103021713

PARTS LIST						
ITEM	QTY	DESCRIPTION	MATERIAL	FINISH	PART No.	DWG No.
1	1	GROUNDING CLAMP MACHINED	BRASS	NATURAL	-	31097
2	1	SHEAR BOLT M10 x 20mm	BRASS	NATURAL	-	31127

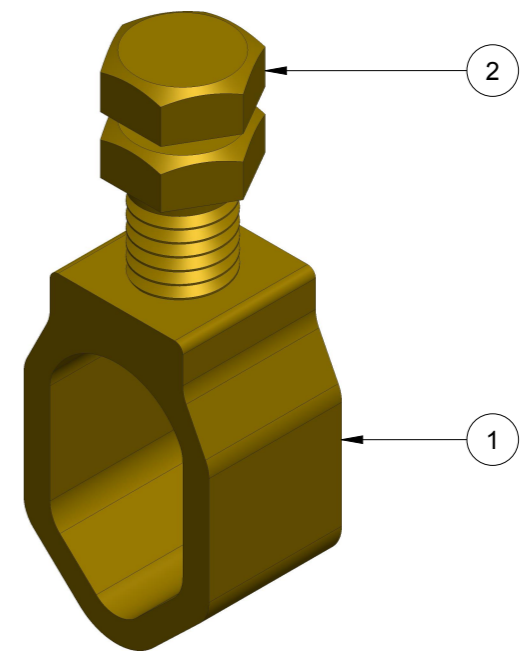
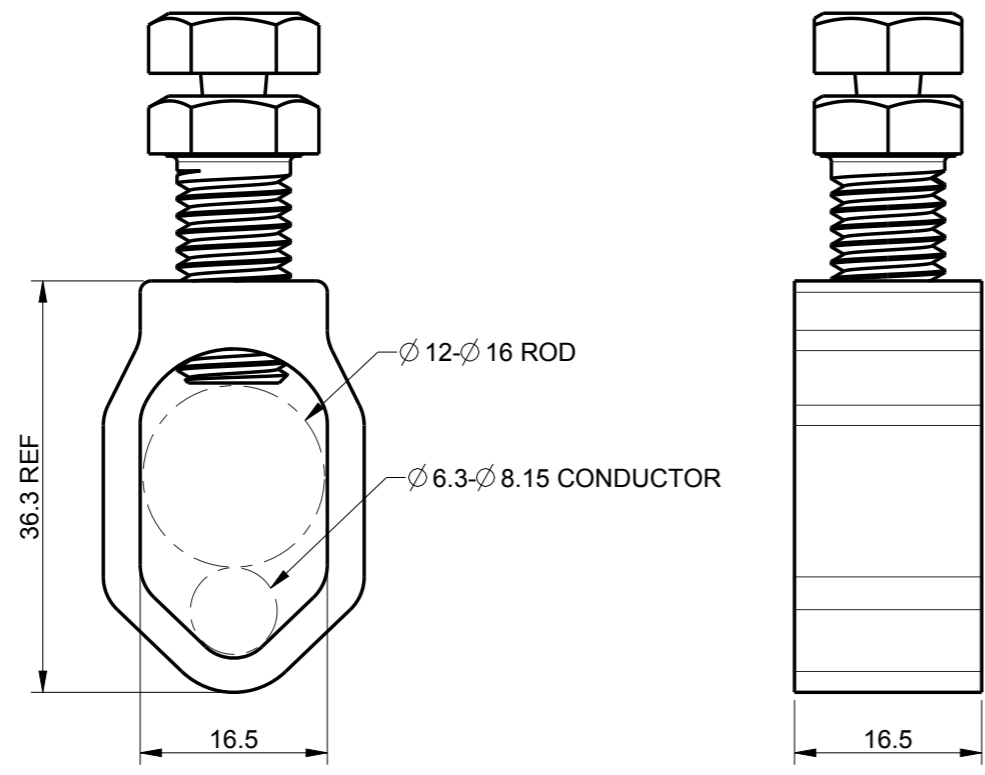

NOTES

- 1. MATERIAL: COPPER ALLOY
- 2. FINISH: NATURAL
- 3. EARTHING MATERIALS SHALL CONFORM TO THE FAULT RATING REQUIREMENTS OF IEC 61230.
ELECTRICAL RATING: 8kA @ 1s FAULT
- 4. TYPE TEST REQUIRED AND TEST REPORT TO BE SUBMITTED

B	05.09.17	YS	RP	IH	5972	1. ADDED EPC ITEM NUMBER TABLE
A	27.07.17	RP	AT	AT	5950	1. NEW DRAWING ISSUE
REV	REV DATE	DRWN	CHKD	APVD	CHANGE NUMBER	DESCRIPTION

UNITS
MILLIMETERS
DO NOT SCALE
THIRD ANGLE PROJECTION

TOLERANCES
UNLESS NOTED

x ± 1
x.x ± 0.4



CONFIDENTIAL
THIS DRAWING IS THE EXCLUSIVE PROPERTY OF ELECTRIC POWER CORPORATION (EPC) AND IS TO BE USED ONLY WITH THE PRIOR EXPRESSED PERMISSION OF EPC

PRODUCTION DRAWING TITLE
GROUNDING CLAMP ASSEMBLY

QUALITY PLAN		DRAWN BY	SPECIFICATION	DRAWING NUMBER
QTY.	LABEL	RP	GND-CONA	30761
0	C	DATE DRAWN	20.04.17	SCALE
0	V	VISUAL INSPECTION	20.04.17	NTS
				SHEET No. 1 OF 1
				ORIGIN
				REV B